

SDWF — Strong-Drive® Floor-to-Floor Screw

Features

- Faster to install than other floor-to-floor connection methods — drive the screw, install the take-up washer and the connection is made from plate to plate.
- Shrinkage compensation ensures a tight connection — even after initial shrinkage and settlement occur.
- Installs from inside the structure, eliminating exterior work on the upper stories and enhancing job safety.
- Fastening can be done before or after exterior sheathing is applied for added flexibility.
- One screw length can be used for multiple floor depths (refer to chart to select appropriate screw size), reducing the need for many screw lengths.
- The SDWF kit includes all required installation hardware.



Product Information and Withdrawal Loads

| Model No. | Size (mm) | Thread Length (mm) | Joist Depth Below (mm) | | Allowable Withdrawal per Thread Penetration (N/mm) | | |
|--------------|-------------|--------------------|--------------------------|-------|--|-----|-----|
| | | | Single 45mm Bottom Plate | | JD4 | JD5 | JD6 |
| | | | Min. | Max. | | | |
| SDWF2720-TUW | 7mm x 508mm | 127 | 320mm | 360mm | 131 | 105 | 80 |

1. Joist depth listed based on the 19mm flooring and 70mm of thread penetration into double top plates.
2. For 300mm deep joists install a 35mm block on bottom plate.

Concentrated Uplift Loads

| Model No. | Single SDWF-TUW with 2/ 35mm top plates | | |
|--------------|---|-----|-----|
| | Allowable Tension Load (kN) | | |
| | JD4 | JD5 | JD6 |
| SDWF2716-TUW | 9.1 | 7.3 | 5.6 |

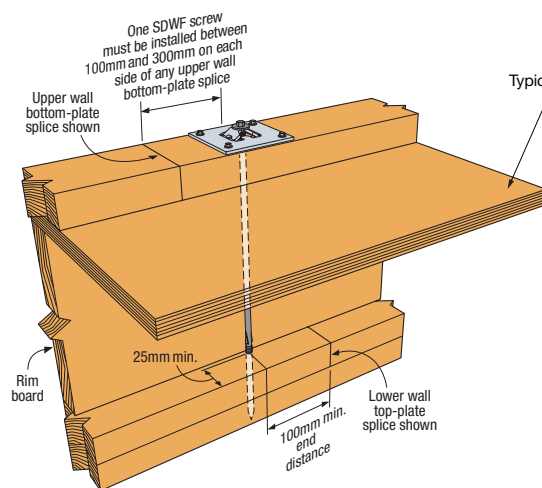

Typical SDWF and TUW Installation

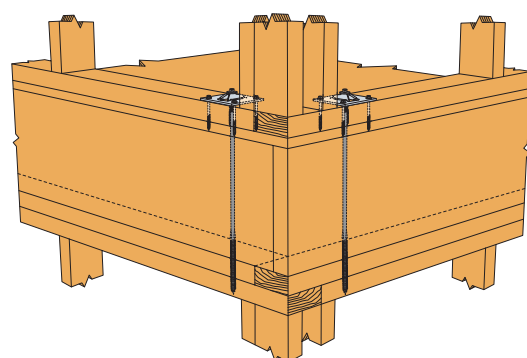

Perspective View of Corner Conditions with Double SDWF-TUW (single SDWF-TUW similar)

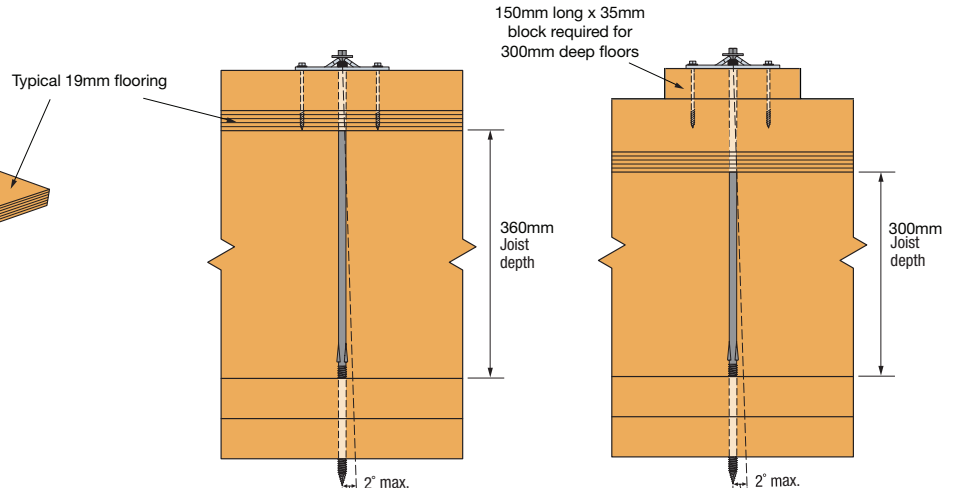

Typical SDWF Angle Limit Installation

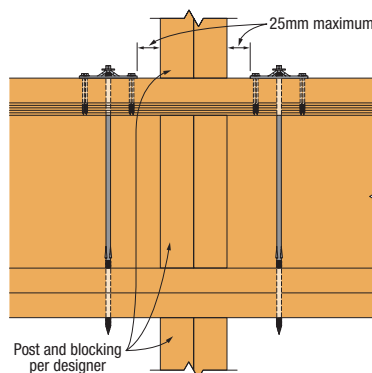

Double SDWF-TUW Concentrated Load Restraint Detail at Continuous Wall (single SDWF-TUW similar)

Note: Stud-to-plate connections (SDWS22) are required to complete the load path and are the responsibility of the designer.