

# Strong-Drive®

## SDPW DEFLECTOR Screw

**SIMPSON**  
**Strong-Tie®**



Typical SDPW installation (127 mm version shown)

**The SDPW Deflector Screw is a premium structural fastening solution that provides a time-saving solution for non-load-bearing walls to trusses and joists.**

With tested lateral-load ratings the SDPW screw is value engineered for strength, installation speed and safety.

The SDPW is designed for superior performance, and it's backed by the best service and product support in the industry.

### Features and Benefits

- Pre-drill bit bores its own hole eliminating the screw from following the timber grain that could cause a miss-installation into the truss/joist.
- Polymer sleeve allows for sliding during deflection, preventing squeaks
- E-coat® for dry service applications and is compatible with treated timber
- Offset driver bit (6-lobe) securely drives SDPW Deflector screw to predetermined screw depth
- Extension allows for overhead installations eliminating the use of a ladder
- Available in two lengths to suit various scenarios

US Patent 8,458,972 applies to Strong-Drive SDPW Solution  
US Patent 9,523,383 applies to 152 mm (6") SDPW Deflector fasteners

### Application

- Non-load bearing wall connections to truss/joists (including I-joists)

### Finish

- E-coat® Electrocoating
- For further details refer to corrosion information

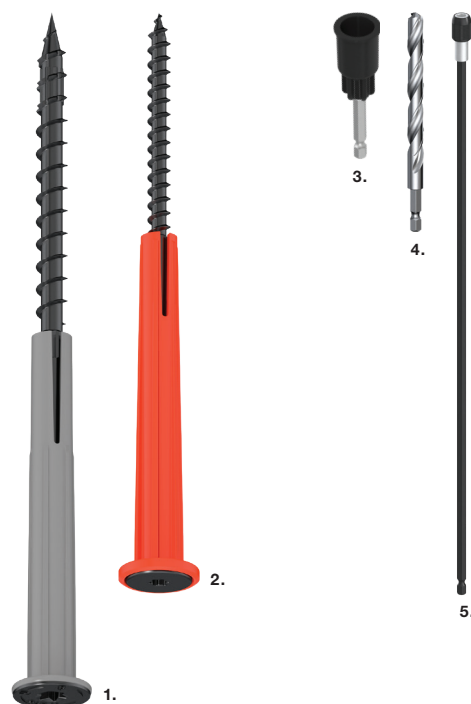

1. 5.0 x 152 mm SDPW19600
2. 3.5 x 127 mm SDPW14500
3. Offset Driver Bit included in every pack and required
4. Drill Bit  $\frac{3}{8}$ " (9.5 mm) x 5" (127 mm) included in every pack and required
5. Extension 450 mm PW18EXT (sold separately)

SCAN FOR MORE INFORMATION

Australia



# Strong-Drive®

## SDPW DEFLECTOR Screw

**SIMPSON**  
**Strong-Tie®**

### Typical Installation

1. Attach extension with drill bit to drill/driver motor.
2. Predrill into top plate only.
3. Replace drill bit with offset bit.
4. Drive SDPW Deflector Screw through predrilled top plate and into the truss or ceiling joist

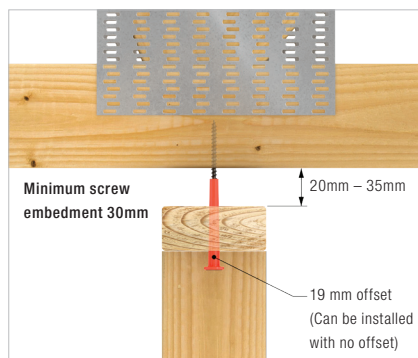
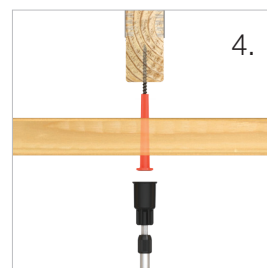
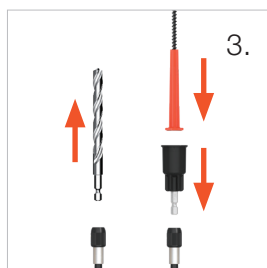
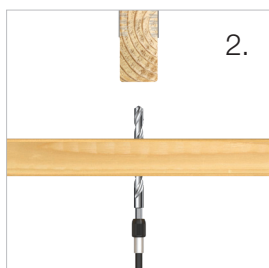
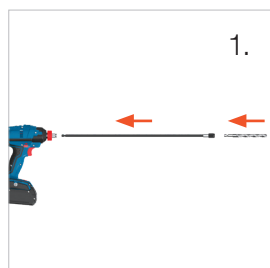

**127 mm**

For single 35 mm top plate connections, providing a 20 – 35 mm gap (between top plate and truss/joist)

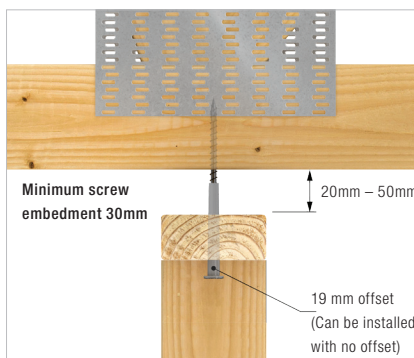

**152 mm**

For single 35 mm top plate shear connections, providing a 20 – 50 mm gap (between top plate and truss/joist)

### SDPW Deflector Screws

Size (mm)	Thread Length (mm)	Head Dia. (mm)	Drive Type	Sleeve Length (mm)	Sleeve Color	Model No.	Fasteners per Pack	Barcode	Dimensions	Pack (WxLxH) Ctn (WxLxH)
3.5 x 127	51	14	T25	76	Orange	SDPW14500-R50	50	707392014454	95 x 194 x 76 mm	0.83 kg
						SDPW14500MB	500	707392014485	203 x 203 x 248 mm	4.98 kg
5.0 x 152	70	16.5	T40	76	Grey	SDPW19600-R50	50	707392014461	95 x 194 x 76 mm	1.54 kg
						SDPW19600MB	400	707392014492	203 x 203 x 248 mm	9.24 kg

**Note:** 50 packs are 6 per carton and include (1) offset driver bit and (1) 5/8" predrill bit. Bulk packs include (2) offset driver bits and (2) 5/8" predrill bits.



### SDPW Accessories

Model No.	Description per Pack	Packs/Ctn	Barcode	Dimensions	Pack (WxLxH) Ctn (WxLxH)
PWKIT25T	<b>T25 Bit Kit:</b> 1 x Quick Release Predrill Bit (5/8" (9.5 mm) x 5" (127 mm)), 2 x T25 Offset Driver Bits	12	707392014508	44.5 x 168 x 44.5 mm	0.10 kg
PWKIT40T	<b>T40 Bit Kit:</b> 1 x Quick Release Predrill Bit (5/8" (9.5 mm) x 5" (127 mm)), 2 x T40 Offset Driver Bits	12	707392014515	152 x 159 x 178 mm	1.20 kg
PW18EXT	1 x <b>Extension</b> 450 mm	15	707392014522	44.5 x 168 x 44.5 mm	0.10 kg
				152 x 159 x 178 mm	2.10 kg